

GERMAN
POOL



德國寶

智能熱水控制系統
家用伺服器
HSX Home Server

HSX



在使用之前請詳細閱讀「使用說明書」及「保用條款」，並妥為保存。
Please read these instructions and warranty information carefully
before use and keep them handy for future reference.



使用說明書 USER MANUAL

請即進行保用登記！

有關保用條款細則，請看本說明書最後一頁。

Please register your warranty information now !

For Warranty Terms & Conditions,
please refer to the last page of these operating instructions.

目錄

重要提示	03
1.1 如何使用本使用及安裝說明書	
1.2 安全指引	
設備簡介	04
2.1 概覽	04
2.2 技術規格	05
2.3 尺寸	06
2.4 包裝內含物	06
安裝	07
3.1 安裝條件	07
3.2 安裝位置	08
3.3 掛牆安裝	08
3.4 初次使用	09
使用方法	11
4.1 介面及信號燈	11
4.2 家用伺服器與現有網路的連接	12
4.2.1 通過無線網路連接家用伺服器	12
4.2.2 通過網路電線連接家用伺服器	13
4.3 軟件更新	13
4.3.1 APP更新	13
4.3.2 家用伺服器的軟件更新	13
4.4 如何使用APP	14
4.5 恢復出廠設定	17
4.5.1 重設APP	17
4.5.2 重設家用伺服器	17
4.6 清潔與保養	17
疑難排解及客戶服務	18
5.1 客服地址	19
廢物處理	20
6.1 環境與回收利用	20

重要提示

重要提示

- 使用及安装前，请先细阅本使用及安装说明书。
- 请妥善保存本使用及安装说明书，以便日后需使用。

1.1 如何使用本使用及安装说明书：本使用及安装说明书只供专业技术人员及终端用户使用。

1.2 安全指引

- 除非IT网络受防火墙保护，否则切勿将设备连接到任何IT网络，以防止未获授权人士使用设备。
- 请使用安全的无线网路密码，以防止未获授权人士使用设备。密码必须由字母、数字及特殊符号组成。
- 设备仅可于密闭空间使用，请避免极端环境对设备的影响，潮湿、高温、震荡及阳光直射可能会对设备造成损坏。
- 请确认通风口没有阻塞，避免因温度过热而造成设备损毁。
- 请使用专用的电源线，不当的电压和极性会损坏设备。
- 请勿擅自拆卸设备。不正确修理可能会危及用户。
- 使用操控应用程式（以下简称为APP）遥控控制热水器时，请确保同一时间无其他用户正在使用热水器。对儿童来说高于约43 °C的热水是非常热的，并可能引起灼烧感。可启动的温度保护装置远优于远端控制。
- 凡在有适当监督下，或已事前获悉家用电器使用安全说明，并了解相关危害的前提下，8岁以上儿童及身体、感官或心理障碍者或经验或知识不足者，亦可使用本机器。禁止儿童在随意操作本热水器。禁止儿童在未经适当监督的情况下进行清洁及维修保养工作。
- 同时也请注意热水器的操作及iPad的安全应用。这些注意事项在相应的指引中提供。

設備簡介

2.1 概覽

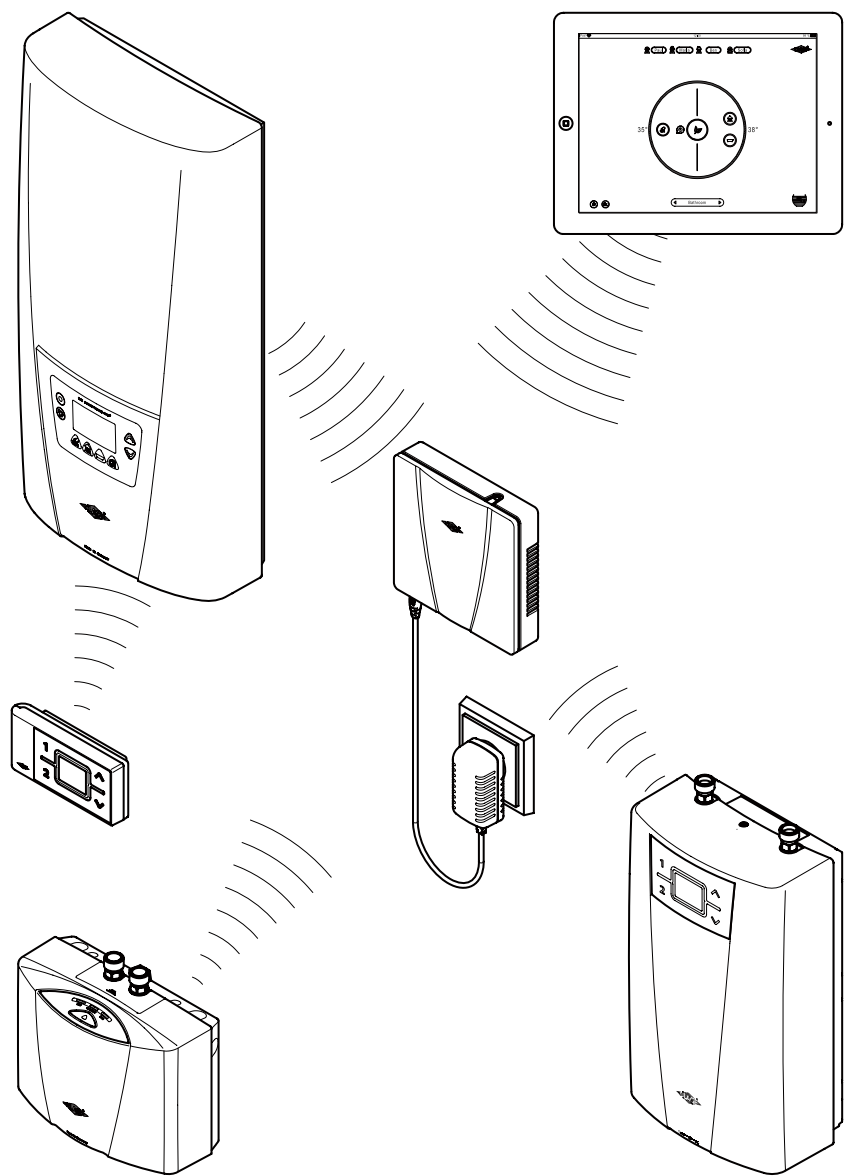

設備簡介

佳捷家庭即熱式熱水器是一款綜合型熱水器，配備了無線網路控制器及無線電適配器，使其能作為一個連接介面，連接APP與DSX、DEX、CFX、CEX和GPI-M8等型號的熱水器。伺服器提供多種必要服務，以通過APP控制出水溫度及取得熱水器的運行參數。

APP為家用伺服器的使用介面。您可以通過觸屏隨心控制熱水器，並管理使用者的個人檔案及資料數據。

2.2 技術參數

類別	智能操控家用伺服器
電壓/伏	100-240（50/60赫茲）
功率/瓦	3
尺寸（除電源線）高*寬*深/毫米	137*142*38
重量/克	330
環境溫度/攝氏度	0-50
空氣濕度/百分比	<70（非冷凝）
無線網路/吉赫	2.4（802.11b/g/n）
無線網路範圍/米	取決於建材
天線介面（可選）	MMCX
無線電頻率/兆赫	868.3
無線電有效範圍/米	10（含牆面）
最多可連接的熱水器數量/台	10

設備簡介

2.3 尺寸

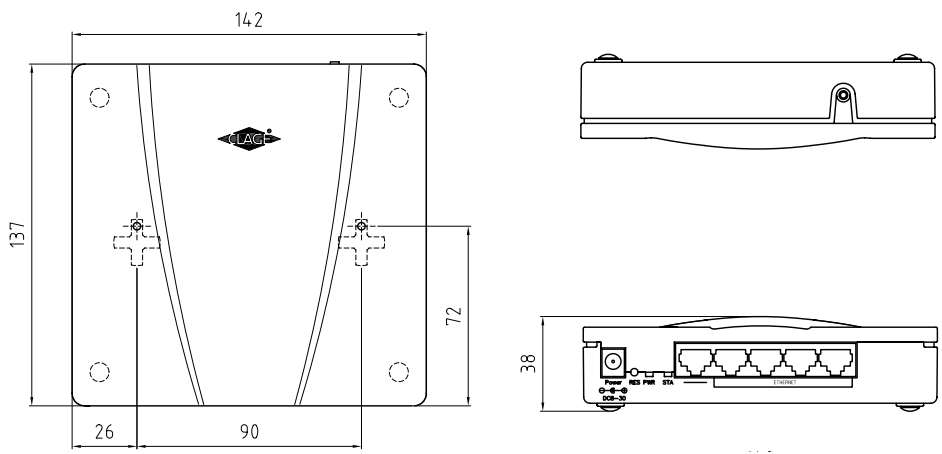

2.4 包裝內含物

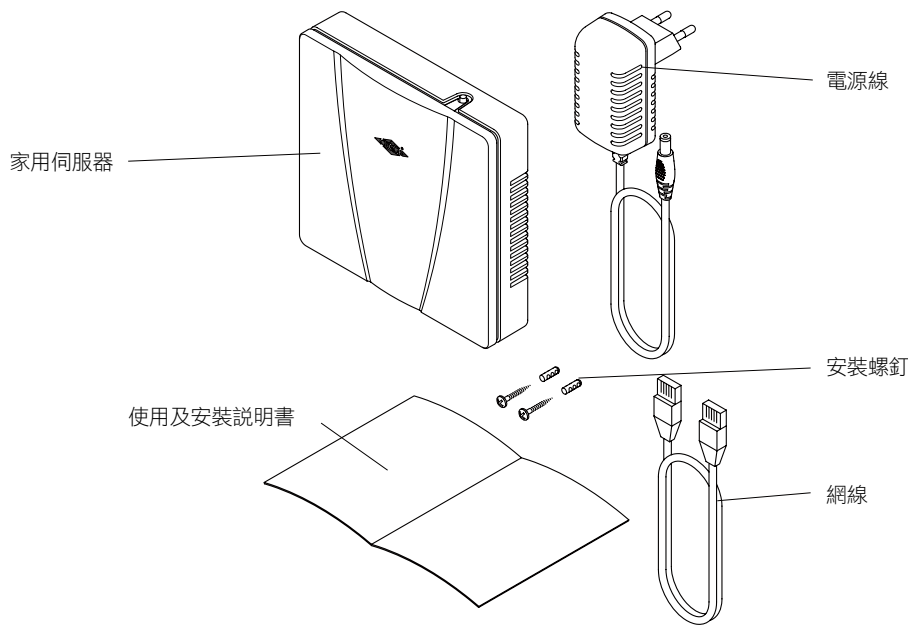

安裝

只有經認可的專業人員方可從事本設備的安裝、初始操作及維護工作，該等專業人員須遵守適用標準及安裝規定。德國寶不對由於未遵守以下說明而導致的任何損害負責。

使用家用伺服器所需工具：

- 最少一台2013年4月1日後出產的DSX、DEX、CFX、CEX或GPI-M8熱水器（生產日期識辨方法：每台產品都有專屬的12位元的系列號。如：系列號*DDDDD-XXXXXX：當DDDDD \geq 13091，即表示該設備產於2013年4月1日後生產。）
- 使用家用伺服器時，即熱式電熱水器必須裝有無線電元件。無線電元件在系列DSX和CFX出廠時已安裝配備，必要時可以作為上述其他型號熱水器的配件運用（型號：3200-34031）。
- 一台備有iOS5或iOS6作業系統的iPad。
- 安裝APP時需有一個蘋果帳戶，以及進入蘋果AppStore的許可權。

3.2 安裝地點

請確認以下兩點：

1. 在安裝的規定範圍內，在電源線（大概1.7米）的有效範圍內預留一個可用插頭。
2. 所有的熱水器均要安裝在距離家用伺服器安裝位置的10米範圍內。家用伺服器可安裝在穩固的地面上，或者垂直懸掛在牆上使用。

提示：請不要在干擾源（如微波）或在金屬表面附近使用該設備。以確保安全穩定的無線連接及實現最佳的無線覆蓋範圍。

安裝

3. 3家用伺服器的牆面安裝

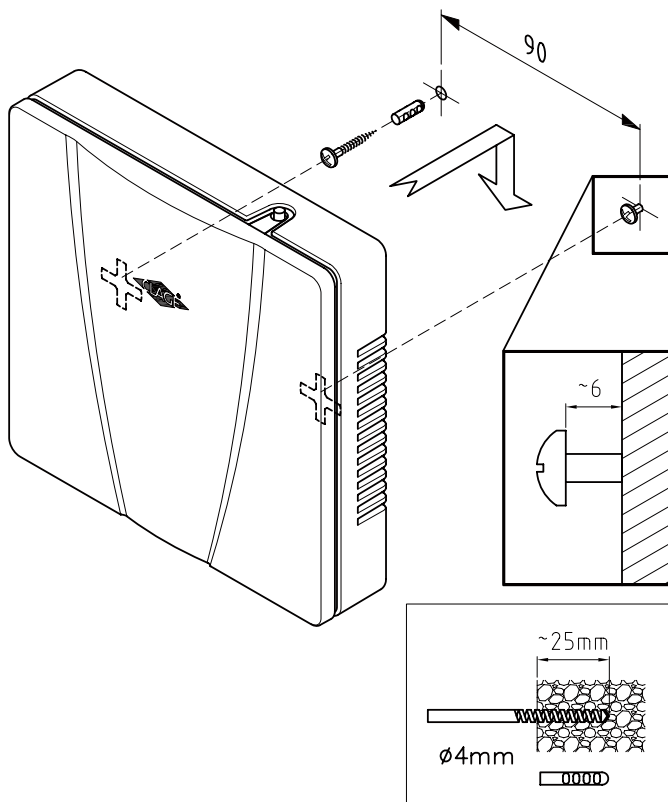

圖片4 牆面安裝方法

1. 借助本使用及安裝說明書所附的安裝模型圖確認好鑽孔位置。請確保螺絲在十字進孔的上端。
2. 用跟機的螺釘，以及直徑4mm的鑽頭鑽至牆體25mm深。
3. 把木栓塞到鑽孔，然後用螺絲擰緊，直至牆體到螺帽的距離剩下6mm。
4. 把家用伺服器上的十字進孔放入螺絲中。
5. 請暫時不要用提供的電源線連接伺服器。請閱讀「初次啟動」章節後再操作。

安裝

3.4 初次啟動

1. 請確保所有受控於家用伺服器的熱水器通電。
2. 用所提供的電源線連接伺服器，然後插進插座。請注意選擇合適的插座（在說明書上和在銘牌上有相應的技術參數）。
3. 在您的iPad上安裝操控APP。在蘋果AppStore中搜索「CLAGE Smart Control」。然後安裝該軟件。安裝後請暫勿啟動該程式。



App 圖標

4. 連接家用伺服器與iPad

- a. 在iPad設定中選擇Wi-Fi，通過無線網路連接 iPad與伺服器：
名稱=CLAGE-HS...（省略號是銘牌上印製的MAC地址的後四位）
密碼=Warmwasser
- b. 或者您也可以通過網路電纜用路由器連接伺服器。在此種安裝情況下，如果在初次使用時出現故障，可以通過無線連接方式重新連接。

5. 應用設置：

- a. 啟動APP，系統會察知您是家用伺服器新用戶。
- b. 點擊「安裝」鍵，進入設置菜單。
- c. 點擊您想要設置的伺服器，然後選擇「添加伺服器」。
- d. 點擊新添加的伺服器，以便打開設置頁面。
- e. 在設置頁面您可以為新增的伺服器更名及檢查連接狀態。
- f. 點擊「可用設備」，可檢索出在家用伺服器有效範圍內的所有熱水器。（如沒成功搜索出所有熱水器，請重複該步驟。）您也可以將標記為未連接的加熱器連接至伺服器，點擊「熱水器」欄，以及確認安全查詢。
- g. 需要時請連接其他的熱水器至伺服器。
- h. 點擊功能表項目中的「空間」選項，並給它命名。在「空間」選項裡，有可控制應用的按鍵。
點擊「創建 空間」，確認之前的錄入資料。必要時再添加更多空間。
- i. 點擊功能表列中的「設備」，然後點擊「最新設備」。
- j. 在配置功能表列中的欄目，每個按鍵有相對應的設備，請整理歸類。
- k. 命名設備，然後根據需要設定最高溫度值。

安裝

- l. 點擊命名後的空間按鍵，然後點擊「+」，添加新任務（洗手或者淋浴）。
- m. 您可以在下拉式功能表下改變任務或標準溫度。需要時您也可以添加更多的任務。
- n. 選擇功能表列中的「用戶」，命名並選擇頭像圖示。
- o. 點擊「新增用戶」以確認添加操作。有需要時，可以添加其他用戶。
- p. 點選已設置好的使用者，然後在配置功能表列中選擇「溫度」。根據使用者喜好設置相應的溫度。
- q. 點擊「主頁」，關閉配置功能表。通過在出水時調校其中一台熱水器的溫度，檢查控制功能是否運行正常。錶盤上的選定額定值展示了工作狀態中機器的耗電量 (0至100%)。在APP上的溫度變化將自動在熱水器上顯示。
6. 家用伺服器可以直接連至當前可用網路（「用戶端」），或者（「接入點」）連至無線網路。
當伺服器以第一種方式連至路由器時，它將自動切換至用戶端運行。作為用戶端的伺服器配置方法可參考「應用」章節。
如果您想把伺服器作為一個接入點使用，則必須設置個人安全密碼，防止未經授權的使用：
 - 在配置功能表中選擇「家用伺服器」選項，確認您想要加密的家用伺服器。
 - 選擇「更多」，在「網路密碼」中設置一個僅有本人知道的安全密碼。
7. 為了獲取使用家用伺服器的許可權，請在www.clage.de/de/service/geraeteregistrierung 網址上用郵箱地址登記註冊您的家用伺服器。

使用方法

伺服器是作為iPad及熱水器的連接介面。熱水器的控制及伺服器的設置都由APP來實現。有關APP的應用方法，請仔細閱讀「APP應用」章節，或點擊配置功能表列上的「i」選項。配置功能表即為主畫面左下角的「齒輪」圖示。

4.1 介面及信號燈



圖5

提示：請使用所提供的電源連接家用伺服器。

家用伺服器通過無線電及無線網路與其他設備連接。另外，伺服器也可通過網線連接路由器，作為DHCP客戶聯網。當網線正確插到乙太網插口時，無線網路將會自動取消連接。注：最左邊的RJ45插口不可用。

為了增強家用伺服器的無線網路覆蓋範圍，可以添加一個帶無線射頻功能的天線介面。該介面可以增強家用伺服器和iPad間的聯網品質，但並不能增加伺服器與熱水器的聯網品質。有關介面在專門店有售。當家用伺服器透過電源線通電時，「電源信號燈」閃爍。

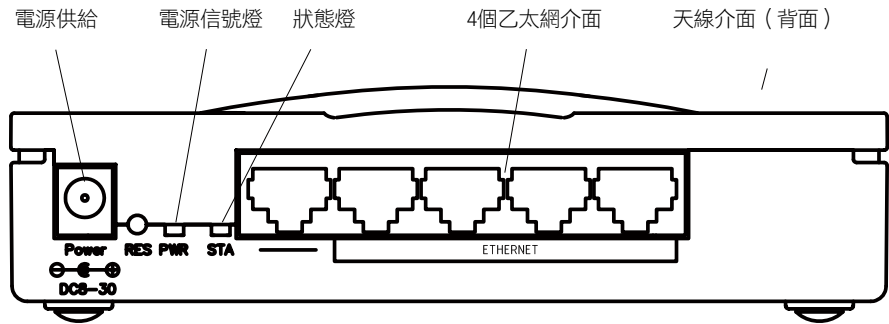
當伺服器作為接入點連接至無線網路時，「狀態燈」閃爍。如果出現信號燈閃爍情況，代表家用伺服器存在故障問題。這種情況下必須聯繫客服。

使用方法

4.2 家用伺服器連接至當前可用網路

家用伺服器可以完全獨立運行（作為接入點），或者作為用戶聯網運行。為方便使用，建議選擇後者，因後者可連接無線網路或有線網路。

提示：為了使伺服器通過無線連接聯網，無線網路名稱和密碼是必須的。

4.2.1 通過無線連接家用伺服器

1. 在配置功能表中選擇「家用伺服器」。點擊您想設置的伺服器後再點擊「建立連接」，以確認連接狀態。點擊「更多」按鈕然後選擇「客戶」。
2. 在「網路選擇」欄上點擊您想連接的網路，然後設立一個密碼。如果您使用的是隱藏的SSID，則必須要取消隱藏，直到網路可見。
3. 點擊「接納設置」。
4. 家用伺服器完成無線網路設置，並會嘗試以新通道資料在路由器上註冊登記。iPad在切換中登錄至家用網路。請您在無線設置下查看iPad的無線連接狀態。
5. 返回APP。在成功註冊家用網路後，家用伺服器MAC地址的IP位址更改，狀態燈熄滅。
6. 在APP中您可以點擊「家用伺服器」→「設置」→「建立連接」，以檢查是否安裝成功。如成功，將會出現「與伺服器的連接正常（Connection to the serve OK.）」字樣。

提示：如果以提供的登錄資料登記失敗的話，短暫等候後，家用伺服器會返回接入點模式。這時候需要重新連接iPad及伺服器，檢查登錄資料。

如果連接至伺服器的無線網路不可用（比如路由器沒有開啟，或者家用網路密碼被更改），家用伺服器在下次啟動時又重新作為接入點的角色啟動。這種情況下可以參照「初次啟動」章節中提及的登錄資料，以便重新登錄至其它網路。

使用方法

4.2.2 家用伺服器連網

1. 請把網線一端插至伺服器中的其中一個Ethernet埠，另一端連至路由器。
2. 家用伺服器自動取消無線連接，連接入使用者服務端。狀態燈此時熄滅。
3. 在APP中您可以點擊「家用伺服器」→「設置」→「建立連接」，以檢查是否安裝成功。如成功，將會出現「與伺服器的連接正常（Connection to the server OK.）」字樣。

4.3 軟件更新

4.3.1 APP更新

- 為了保證家用伺服器的安全與流暢的運行，我們建議您使用最新版本的軟件。
- 當有新版本的APP可用時，會在Appstore裡展現。進行軟件更新時，在Appstore介面的右方選擇「更新」按鈕。

4.3.2 家用伺服器軟件的更新

提示：當家用伺服器正在更新的時候請勿關閉電源。

當家用伺服器可更新時，您將會在當初在CLAGE註冊的郵箱地址收到通知。在該郵件裡下載最新的家用伺服器軟件並按其所述步驟進行安裝。

您可以在www.clage.de/de/service/geraeteregistrierung註冊您的郵箱，以便獲悉最新的可用更新資訊。

使用方法

4. 4 APP的使用

APP 由三個元素組成：「主頁」、「資料庫」及「配置功能表」。後兩者可以直接在「主頁」上找到。



圖6 「主頁面」

您可在主頁面進行連接及控制溫度。另外當前的預設溫度資訊，預設時間及節能目標也能呈現。

在溫度控制盤上，每個鍵都被線分隔開來，每個鍵都至少有一個功能，此外也用於顯示相應裝置的當前溫度值。按功能鍵即可設定在配置功能表中預存的溫度。選擇用戶，則該用戶預設的溫度值將被自動設定。如果想設置短時間的溫度變化，長按相應鍵的功能鍵，並轉動溫度控制盤，直到顯示相應溫度。

使用方法

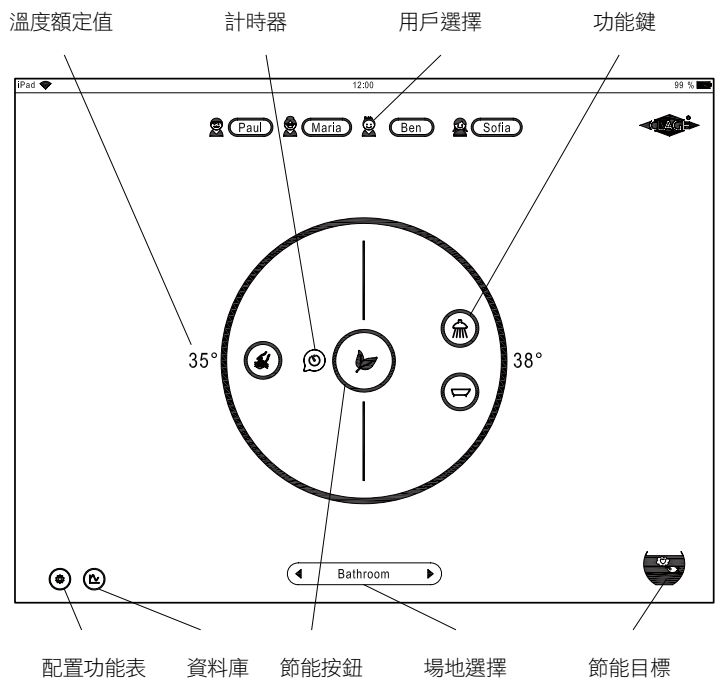

圖7 配置功能表列

為了能廣泛使用該APP的所有功能效果，配置欄必須附有例如空間，使用者和能耗等條件。
配置功能表分為不同的種類。功能表列中各自的選項資訊可以通過點擊「提示資訊」獲取。

警告：在計時器設置時請注意。預設溫度會在預設的時間啟動，預設溫度會顯示在當前的溫度顯示幕上，但是熱水器當前溫度與此設定溫度無關。

使用方法

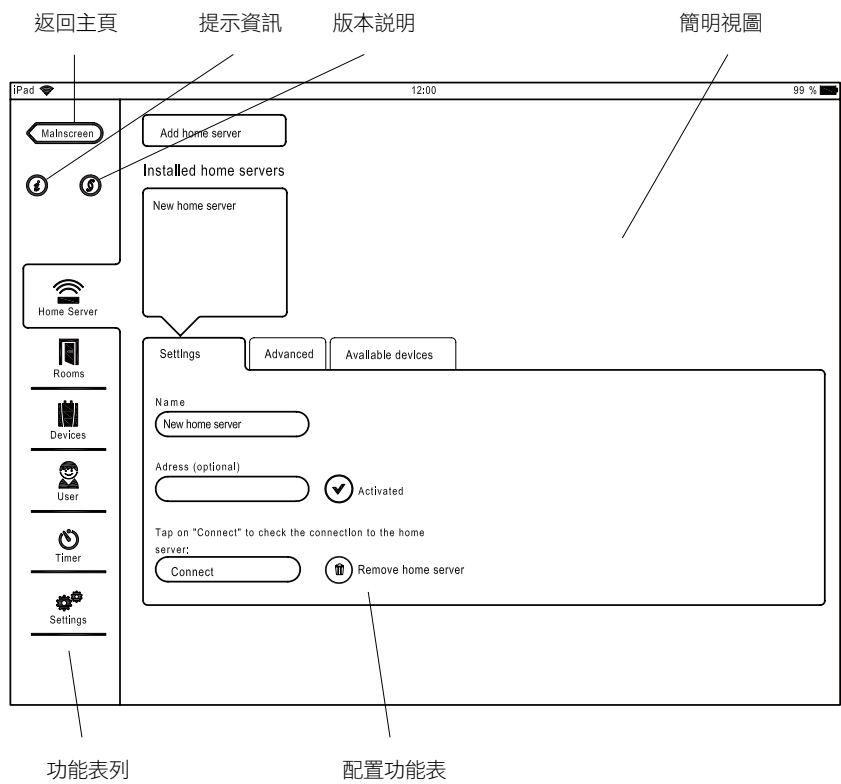

圖8 「資料顯示」

從「資料顯示」中可以看到使用及耗能參數。為能準確呈現所耗費用，要在配置功能表的「設置」輸入現時的水費與電費。

提示：
耗能參數僅供參考。

在家庭伺服器斷電後，請用 iPad 或者其他軟件聯網同步其系統時間。於同步前之任何指示均可能會丟失。

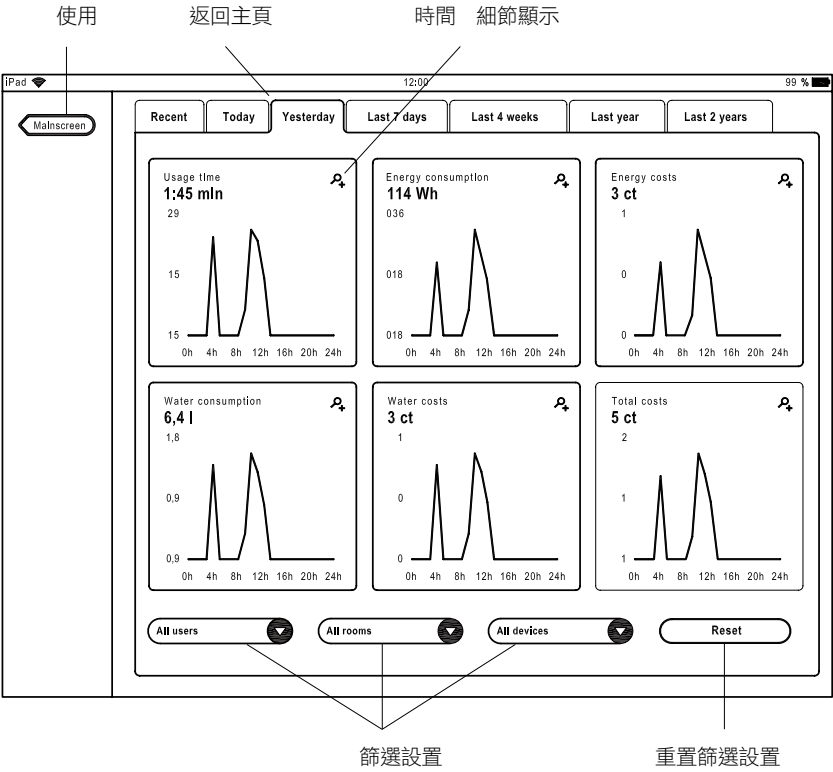
家用伺服器斷電的情況下，使用及耗能參數最後十五分鐘的資料可能會丟失。

使用方法

4.5 恢復出廠設定

4.5.1 APP的重置

必須先移除該APP，然後於AppStore重新下載。

接下來按照「初始啟動」章節內容來進行下一步動作。

提示：我們建議在重新設置後存儲設置的資料，在有必要的時候或新安裝APP的時候，可以從家用伺服器下載之前存儲的資料。針對這一個步驟，您可以在設置的功能表列上選擇「配置」設置。在下拉式功能表中可以選擇已存儲好的配置參數。

4.5.2 家用伺服器的重置

為操作家用伺服器，如曾重置密碼，則必須拔掉電源，靜候一會後重新插上電源。

家用伺服器在完成重啟（有可能長達一分鐘）後大約三分鐘後，會在出廠狀態中顯示為接入點。在此期間狀態燈會持續閃爍。要改變家庭服務中的無線配置，可以在家用伺服器上註冊您的iPad，方法如下：

無線網名稱=CLAGE-HS-....（省略號的數字代表在銘牌上印刷的MAC地址的後四位）

密碼=Warmwasser

提示：如果在三分鐘後作出改動，則家用伺服器中會顯示最後的無線設置。

4.6 清潔與維護

應避免家用伺服器及其電源線受潮，以防損壞電路。如須清理家用伺服器及電源線，請先拔掉電源，然後用乾軟毛巾擦拭表面，請勿使用任何清潔溶劑。

疑難排解及客戶服務

該產品生產嚴格，在交貨之前亦通過多次合格檢測。如出現故障問題，僅屬於個別現象。請您確認一下能否根據下表解決故障問題，以節省不必要的服務費用。

問題	可能性原因	解決方法
APP無法搜索到家用伺服器	家用伺服器未正常啟動	以電源線連接家用伺服器
	超過無線網絡接受範圍	將iPad放在更靠近路由器或家用伺服器的地方
		將外接天線接收器連接到家用伺服器
	未啟動iPad無線網絡(打開了飛行模式)	重啟或打開無線網絡
	iPad無法連接上家用伺服器所在網路	改變iPad的無線網路設置
APP無法搜索到某個熱水器	未啟動熱水器	檢查熱水器開關是否已經打開
	家用伺服器與熱水器之間距離太遠	改變一下家用伺服器和內天線介面的位置
		縮短家用伺服器與熱水器之間的距離
APP無法搜索到任何一個熱水器	家用伺服器並未啟動	檢查伺服器是否通電，並檢查網線是否連接妥當
熱水器無法對APP做出反應	無線連接不穩定	將iPad放在更靠近路由器或家用伺服器的地方
	未啟動熱水器	檢查熱水器開關是否已經打開
	熱水器從家庭伺服器中退出登錄	在家用伺服器中重新登錄熱水器
在APP上無法顯示功率，但出水正常	啟動溫度高於額定溫度	不需要解決

問題	可能性原因	解決方法
顯示的溫度不穩定	手動調控	協調控制使用
	手動調控FX無線遠端服務	協調控制使用
		將外接天線接收器連接到家用伺服器
		協調控制使用
	調控另一台 iPad	協調控制使用
	防燙傷保護啟動	取消熱水器上的防燙傷設置
狀態燈閃爍	內部故障	聯繫客服

5.1 客服地址

若仍無法解決故障，請您聯繫下方地址

德國寶（香港）有限公司
香港九龍紅磡暢通道1號中旅貨運物流中心8樓
電話：+852 2333 6249
傳真：+852 2356 9798
電郵：repairs@germanpool.com
網址：www.germanpool.com

如果設備存在瑕疵，請把該設備和單據寄回我司檢查及／或維修。

廢物處理

環境與回收利用

該產品是由高質的元件與材料組成的，均可回收與重複利用。在產品上的這些標記，代表著這些電子（氣）產品必須和家庭生活垃圾分類處理。請您把這些產品帶到當地的原材料回收處，比如可回收物品收集處，這些地方可以免費接收處理。正確地處理這些產品的，有利於環境保護，並減少對人和自然的危害。關於最近的垃圾回收處資訊，可從當地政府獲悉。對於商業用戶來說：如果您想要處理這些電子（氣）設備，請聯繫代理商或供應商。他們會給您提供進一步的資訊，此標記僅適用於歐盟。

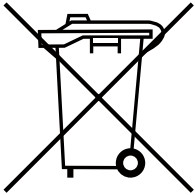

蘋果、蘋果商標、iPad及iOS均是蘋果股份有限公司的品牌，均在美國以及其他的國家已經登記註冊。
AppStore和Apple Store均是蘋果股份有限公司的專屬服務品牌，均在美國及其他的國家登記註冊。

Table of contents

1. Important notes	22
1.1 How to use this instruction manual	
1.2 Safety instructions	
2. Description of the device	23
2.1 Overview	23
2.2 Technical data	24
2.3 Dimensions	25
2.4 Scope of delivery	25
3. Installation	26
3.1 Prerequisites	26
3.2 Place of installation	26
3.3 Installation of the Home Server on the wall	27
3.4 Initial operation	27
4. Use	30
4.1 Terminals and signal lamps	30
4.2 Integration of the Home Server in the existing network infrastructure	31
4.2.1 Connecting the Home Server via Wi-Fi	31
4.2.2 Connecting the Home Server via LAN cable	32
4.3 Software update	32
4.3.1 Updating the control app	32
4.3.2 Updating the Home Server software	32
4.4 How to use the app	33
4.5 Restoring the factory settings	36
4.5.1 Resetting the control app	36
4.5.2 Resetting of the home server	36
4.6 Cleaning and care	36
5. Self-help in case of problems, and customer service	37
5.1 Customer service address	38
6. Disposal	39
6.1 Environment and recycling	39

Important notes

Important notes

- Before installing or using this device, you must read these instructions carefully until the end.
- Keep these instructions together with the device for later use.

1.1 How to use this instruction manual

- These instructions are intended for experts responsible for the installation of the device as well as for end users.

1.2 Safety instructions

- Protect the device from unauthorised access by connecting it to an IT infra structure connected with the internet only if it is protected with a firewall.
- Protect the device against unauthorised access by using a safe Wi-Fi pass word. The password must consists of letters, numbers and special characters which are not listed in encyclopaedias.
- The device is designed for the use in closed rooms only and must be protect ed against extreme environmental influences because it might be damaged by humidity, heat, vibrations and direct solar radiation.
- In order to avoid damage due to overheating make sure not to obstruct the ventilation slots.
- Use the supplied power pack only; inadequate voltages or polarities will cause damage to the device.
- Never open the device. Improper repairs may endanger the user.
- When using the instantaneous water heater with the control app via the remote control it must be ensured that no other person is using the instan tan eous water heater at the same time. Water temperatures of more than approx. 43 °C may be sensed as hot by children, in particul ar, and can cause the feeling of burn. The temperature protection function which can optionally be activated always supersedes the remote control.
- This appliance can be used by children aged from 8 years and above and persons with reduced physical, sensory or mental capabilities or lack of experience and knowledge if they have been given supervision or instruction concerning use of the appliance in a safe way and understand the hazards involved. Children shall not play with the appliance. Cleaning and user main tenance shall not be made by children without supervision.
- The safety notes for the operation of the instantaneous water heater and the use of the iPad must also be observed. These are provided in the correspond ing manuals.

Description Of The Device

2.1 Overview

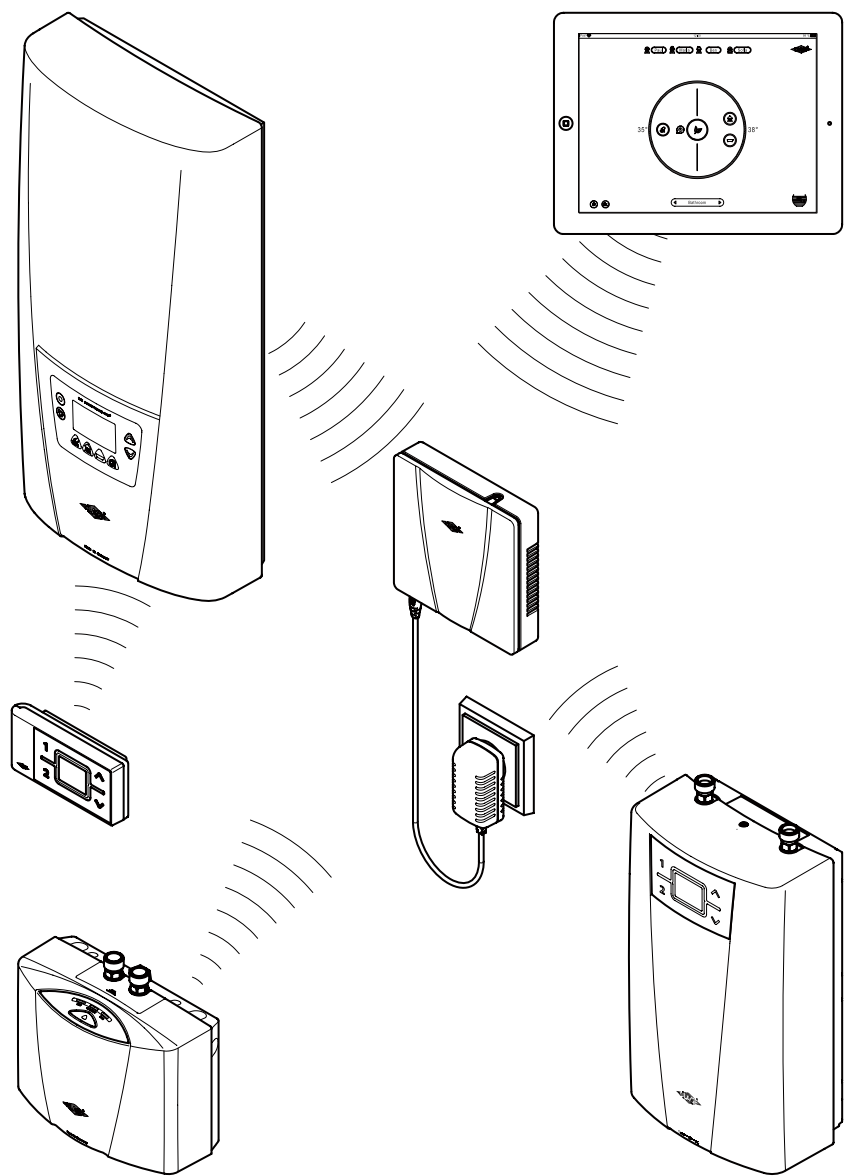

Description Of The Device

CLAGE Home Server is an integrated server which is equipped with a Wi-Fi controller and a special radio adapter. Thus it can be used as interface between the control app and the instantaneous water heaters DSX, DEX, CFX, CEX and GPI-M8. The server provides all services which are required to control the discharge temperature of the instantaneous water heaters and capture the operating data of the instantaneous water heaters by means of the control app.

The control app is the user interface for the home server. It administers individual user profiles as well as consumption data, and allows for the intuitive control of the instantaneous water heaters via a touch screen.

The Home Server can only be used within the local network. Neither control nor data can be accessed from the internet.

2.2 Technical data

Type	Home server with control app
Voltage	100-240 (50/60Hz)
Power	3
Dimensions without power pack (H × W × D)	137*142*38
Weight	330
Ambient temperature	0-50
Air humidity	<70 (not condensing)
Wi-Fi	2.4 (802.11b/g/n)
Wi-Fi range	Depending on the building
Antenna terminal (optional)	MMCX
Radio frequency	868.3
Radio range	10 (incl. one wall)
Max. number of instantaneous water heaters	10

Description Of The Device

2.3 Dimensions

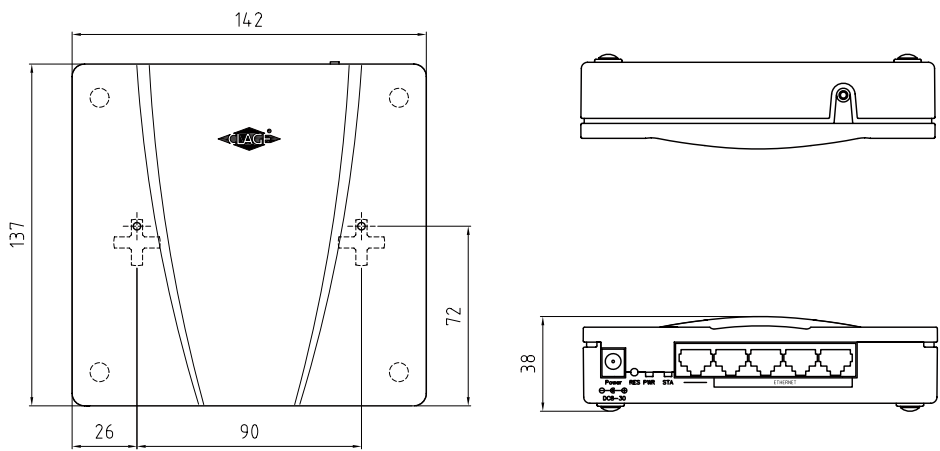

Figure 2: "Dimensions"

2.4 Scope of delivery

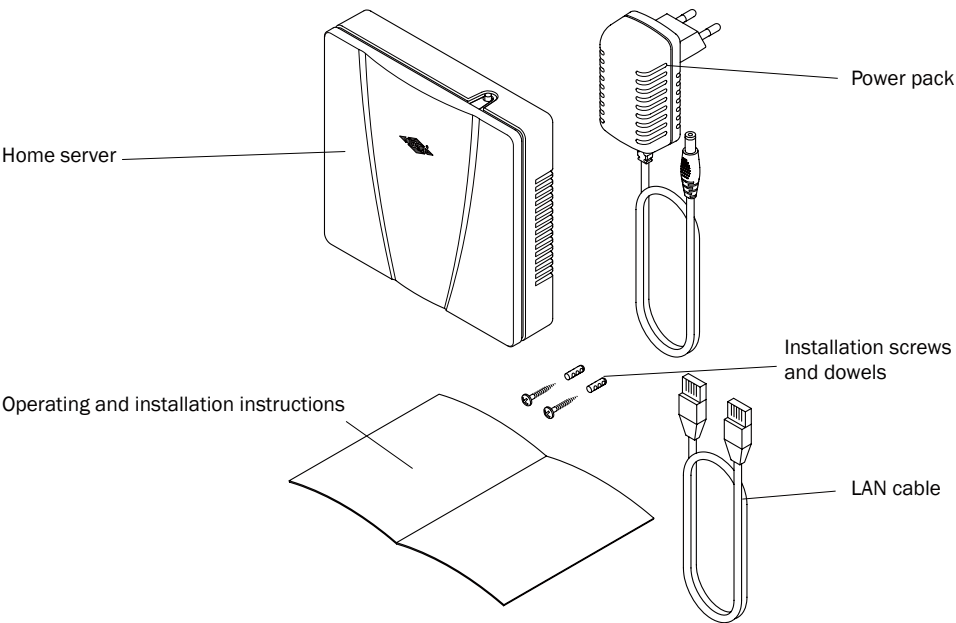

Figure 3: "Scope of delivery"

Installation

The installation, initial operation and maintenance of the device may only be carried out by an approved qualified servicing company which is fully responsible for the compliance with applicable standards and installation provisions. We do not assume any liability for damage caused by the non-compliance with these instructions!

3.1 Prerequisites

The following is required for the use of the home server:

- At least one instantaneous water heater of the series DSX, DEX, CFX, CEX or GPI-M8 manufactured after 1st April 2013 (the date of manufacture is indicated by the 12-digit serial number xDDDDD-xxxxxx; if DDDDD \geq 13091, then the device was manufactured after 1st April 2013.)
- For the use with the home server, the instantaneous water heater must be equipped with a radio module. The radio module is incorporated in the DSX and CFX series ex works; for any other series mentioned above, it can be acquired and retrofit as accessory part (order number 3200-34031).
- An iPad with iOS 5 or iOS 6 operating system must be available.
- For the installation of the control app, an Apple ID and the access to the Apple AppStore is also required.

3.2 Place of installation

Make sure that, at the intended place of installation, a socket is available within the reach of the power supply cable (approx. 1.70m), and that all desired instantaneous water heaters are the power supply cable (approx. 1.70m), and that all desired instantaneous water heaters are positioned at a distance of less than 10m to the intended place of installation. The Home Server can be used either horizontally on a solid ground or vertically mounted on the wall.

Note: Do not use the device in the vicinity of disturbing sources such as microwaves, or in the direct vicinity of metallic surfaces. Otherwise the safe and reliable radio contact and the optimal radio range cannot be ensured.

Installation

3.3 Installation of the Home Server on the wall

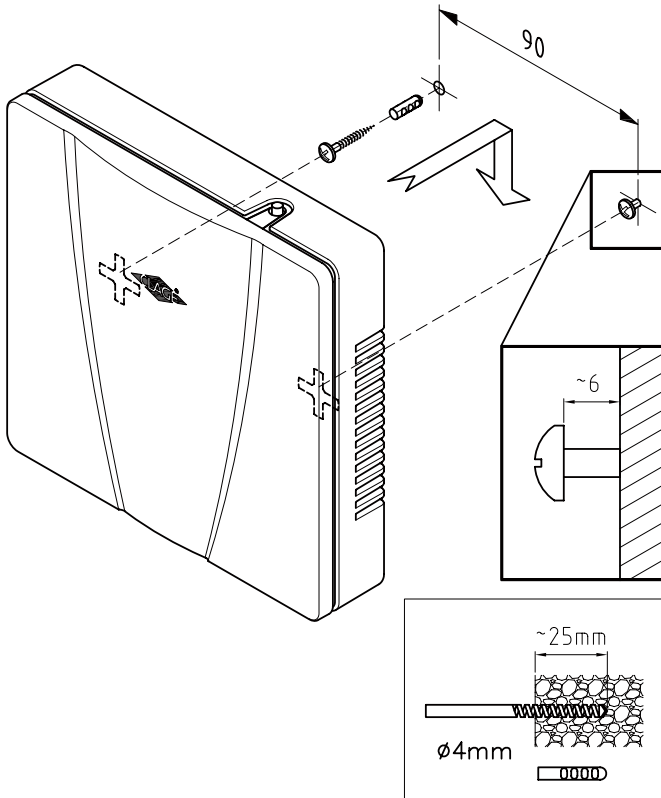

Figure 4: "Wall installation"

1. Determine the position of the boreholes using the template provided inside these operating instructions. Please note that the screws must be positioned at the top of the snap cross.
2. When using the supplied screws and dowels, you must drill holes with a depth of 25mm using an appropriate 4mm-drill.
3. Insert the dowels into the holes and screw in the screws until there is a space of 6mm between the wall and the screw head.
4. Hang the Home Server with the snap cross onto the screws.
5. Do not yet connect the Home Server with the supplied power pack! To this end, read the "Initial operation" chapter.

Installation

3.4 Initial operation

1. Make sure that all instantaneous water heaters which you want to connect with the Home Server are supplied with voltage.
2. Connect the Home Server with the supplied power pack and plug it into the socket. The technical data provided in this instruction manual and on the nameplate of the Home Server must be observed when selecting an appropriate socket.

3. Install the control app on your iPad. To this end, you must select "CLAGE Smart Control" in the Apple AppStore and install the app. Do not yet start the control app.



App icon

4. Connect the iPad with the home server:
 - a. Select Wi-Fi in the Setting menu on your iPad and connect the iPad with the Home Server via Wi-Fi:
Name = CLAGE-HS-... (followed by the last four digits of the MAC address printed on the nameplate)
Password = "Warmwasser" (without quotation marks)
 - b. Optionally, you may connect the Home Server with a router using a LAN cable. In case of problems during initial operation, the setting can be made via Wi-Fi (variant a.).
5. Configuration of the control app:
 - a. Start the control app. You will be informed about detected new home servers.
 - b. You can access the configuration menu by tapping on the "Install" button.
 - c. Tap on the Home Server which you would like to install and select "Add server".
 - d. Tap on the added Home Server to access the configuration field.
 - e. In the "Settings" tab you can enter a name for the Home Server and check the connection status.
 - f. Tapping on the "Available devices" tab will show you a list of all instantaneous water heaters which are within the radio range of the Home Server (repeat this step if the list heaters which are within the radio range of the Home Server (repeat this step if the list of instantaneous water heaters is not complete). Any instantaneous water heater marked with "Not connected" can be connected with the home server. To this end, you must tap on the line of the instantaneous water heater and confirm the security query.
 - g. Connect further instantaneous water heaters with the Home Server as required.
 - h. Tap on the "Rooms" menu item and enter a name for the room with the tap connection which you would like to control with the control app. Tap on "Create room" in order to confirm your entry. Create further rooms as needed.
 - i. Now tap on the "Devices" menu item and there on one of the devices marked with "New device".

Installation

- j. In the configuration field you must now assign the room with the appropriate tap connection to the corresponding device.
- k. Enter a name for the device and limit the maximum temperature, if required.
- l. Select the tab with the room name and tap on the “+” in order to create a new action (e.g. washing hands or taking a shower) for this device in this room.
- m. The type of action can be changed on the pull-down menu and a standard temperature can be entered for this action. Further actions can be created as needed.
- n. Select the “User” menu item and enter a user name and an appropriate icon.
- o. Tap on “Create user” in order to confirm your entry. Create further users as needed.
- p. Tap on the created user and select the “Temperatures” tab in the configuration field. Set the temperatures for the actions as required by the user.
- q. Tap on the “Main page” in order to finish configuration. Then check the function of the control by changing the temperature of one of the instantaneous water heaters while the water is running. A tachometer for the selected target value shows the power consumption (from 0 to 100%) of the active device. Temperature changes in the control app automatically update any existing display values at the instantaneous water heater.

6. The Home Server can either be integrated in an existing network structure (“client”) or provide its own Wi-Fi (“access point”). Any Home Server which is connected to a router via a LAN cable is automatically in client mode. The configuration as a client via Wi-Fi is described in “Use” chapter. If you would like to use the Home Server as an access point, you must create an individual and secure password in order to protect the server against unauthorised access:

- To this end, you must select the “Home server” menu item in the configuration menu and select the Home Server for which you would like to create a password.
- Select the “Advanced” tab and enter a password in the “Network password” field which is secure and known only to you.

7. Register your Home Server together with your e-mail address on

www.clage.de/de/service/geraeteregistrierung”.

Only then you will get access to the software updates for your home server.

The Home Server is used as the interface between the iPad and the instantaneous water heater. The control of the instantaneous water heater and the configuration of the Home Server is accomplished with the control app. For more information on the use of the control app please read the chapter “How to use the app” or tap on the “i” in the configuration menu of the control app. The configuration menu can be accessed via the “toothed wheel” in the bottom left corner of the main screen.

4.1 Terminals and signal lamps

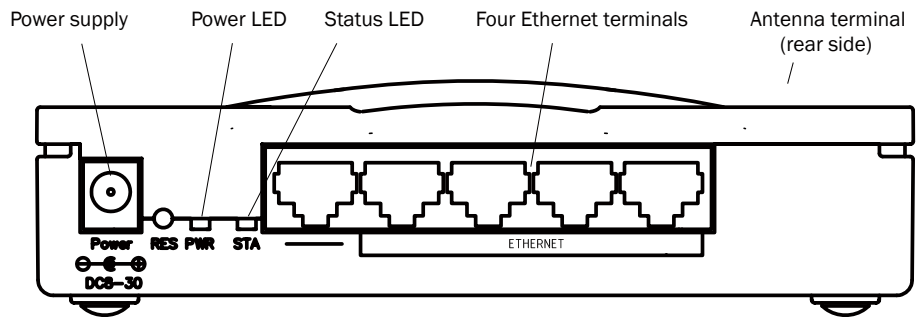

Figure 5:“Connections“

Note: Only use the supplied power pack for the power supply of the home server.

The Home Server communicates via radio and Wi-Fi. As an option, the Home Server can be connected as DHCP client with a router via a LAN cable. The Wi-Fi is disconnected as soon as a LAN cable is connected to one of the Ethernet terminals at the right side of the home server. Do not use the left-hand RJ45 terminal.

In order to increase the Wi-Fi range of the home server, an antenna with M terminal can be used as an option. This additional antenna can improve the connection quality between the Home Server and the iPad, however not the connection between the Home Server and the instantaneous water heater. Suitable antennas are available in specialist shops.

The “Power LED” lights up if the Home Server is supplied with voltage via the power pack. The “Status LED” lights up if the Home Server can be reached as access point via Wi-Fi. If this LED is flashing, the flash code indicates a Home Server error. In this case, you must contact the customer service.

4.2 Integration of the Home Server in the existing network infrastructure

You can either use the Home Server as a stand-alone device (a so-called access point), or integrate it as a client in the infrastructure of an existing home network. For convenient use, we recommend integrating the Home Server in an existing network. To this end, you can either use a Wi-Fi connection or a LAN cable.

Note: In order to integrate the Home Server in a network infrastructure via a Wi-Fi connection, it is necessary to know the Wi-Fi name (the so-called SSID) and the corresponding password.

4.2.1 Connecting the Home Server via Wi-Fi

1. Select the "Home server" menu item in the configuration menu, tap on the Home Server which you would like to install and then tap on "Establish a connection" in order to determine the connection status. Open the "Advanced" tab and select the "Client" operating mode.
2. Tap on the desired network in the "Select network" menu item and enter the corresponding password. If you use a hidden SSID, it must be unhidden during configuration.
3. Tap on "Accept settings".
4. The Home Server updates the Wi-Fi settings and tries to log in on the router using the new access data. The iPad will log in on the home network after switching. Check the Wi-Fi connection of the iPad in the Wi-Fi settings.
5. Return to the control app. After the successful log-in on the home network, the IP address in the MAC address of the Home Server has changed and the status LED goes off.
6. In the control app you can check the successful installation by tapping on "Establish a connection" in the "Settings" tab in the "Home server" menu item. The following text should appear: "Connection to the server OK."

Note: The Home Server returns to the access point mode after a short while if it is not possible to log in with the entered access data. Reconnect your iPad with the Home Server and check the access data.

If the Wi-Fi on which the Home Server has been logged in is no longer accessible (e.g. because the router has been switched off or the password of the home network has been changed), the Home Server will start as stand-alone access point when switched on the next time. In this case, it is possible to access the Home Server with the access data listed in the "Initial operation" chapter. Then you can log in the Home Server on another network.

4.2.2 Connecting the Home Server via LAN cable

1. Connect the LAN cable to one of the four Ethernet terminals at the right side of the Home Server and to one of the open network terminals at your router.
2. The Home Server will automatically deactivate its Wi-Fi connection and switch to client mode. The status LED goes off.
3. In the control app you can check the successful installation by tapping on “Establish a connection“ in the “Settings“ tab in the “Home server“ menu item. The following text should appear: “Connection to the server OK.“

4.3 Software update

4.3.1 Updating the control app

- We recommend using the latest software in order to ensure the impeccable and secure operation of the CLAGE home server.
- Any new control app version will be indicated in the AppStore. For updating your control app, select the “Updates“ tab in the AppStore and tap on the “Update“ button which is to the right of the control app.

4.3.2 Updating the Home Server software

Note: Do not disconnect your Home Server from power supply during updates.

For any available Home Server update, you will receive an e-mail to the e-mail address registered on the CLAGE site informing you of the new update. For download and installation of the latest Home Server software, follow the steps explained herein.

Register your e-mail address on “www.clage.de/de/service/geraeteregistrierung“ in order to receive information on available updates.

4. 4 How to use the app

The app consists of three elements: “Main screen”, “Statistics” and “Configuration menu”. The “Configuration menu” and the “Statistics” can be directly accessed from the “Main screen”.

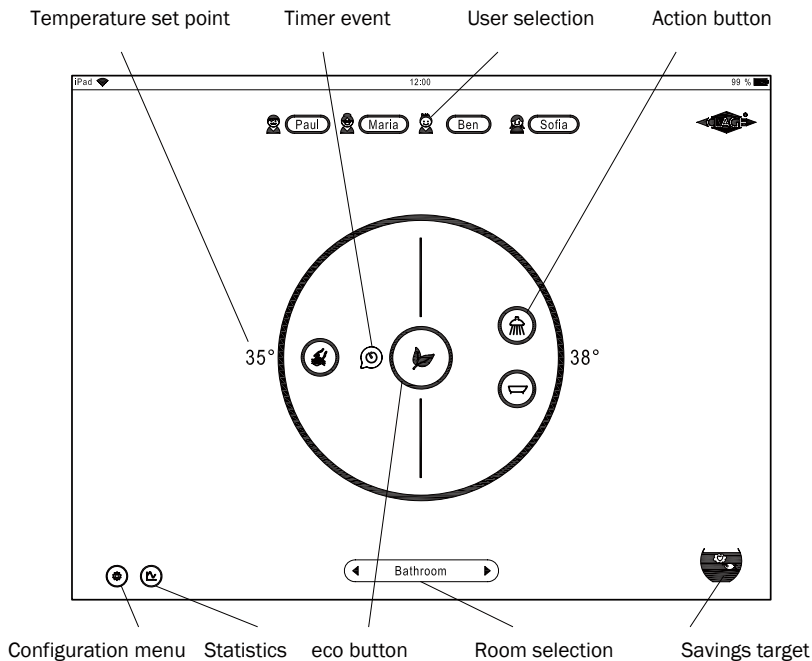

Figure 6 : “Main screen”

Tap connection and temperature control can be accessed on the main screen. Moreover, information on the currently set temperature as well as timers, if set, and savings target, are illustrated.

The tap connections of each room are displayed on the temperature dial plates. They are divided by dashes. At least one action is assigned to each tap connection. Besides that, the current temperature set point of each device is shown. The temperature saved in the configuration menu is set by tapping on the action button. If a user is selected, the temperature saved for this user is set. For short-term temperature changes, keep an action button of the desired tap connection pressed down and turn the temperature dial until the desired temperature is indicated.

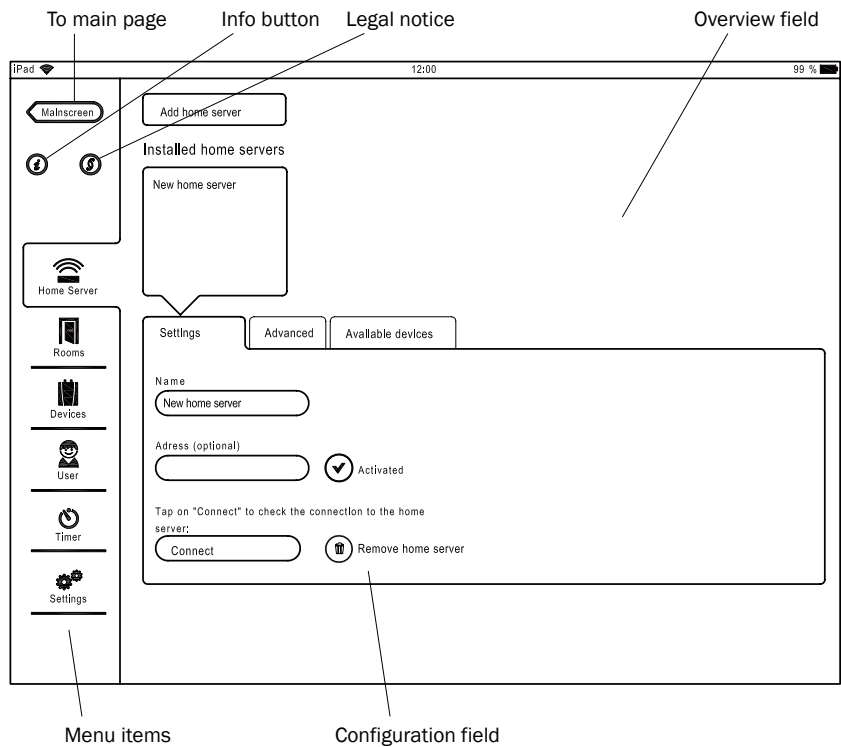

Figure 7: “Configuration menu”

If you want to use all functions of the app, the configuration must be adapted to conditions such as rooms, users and energy prices.

The configuration menu is subdivided into different items. By tapping on the “Info” button, information on the selected menu item is shown.

Warning: Please note that the set temperature for any timer settings will be activated at the selected time – irrespective of any use at this point in time.

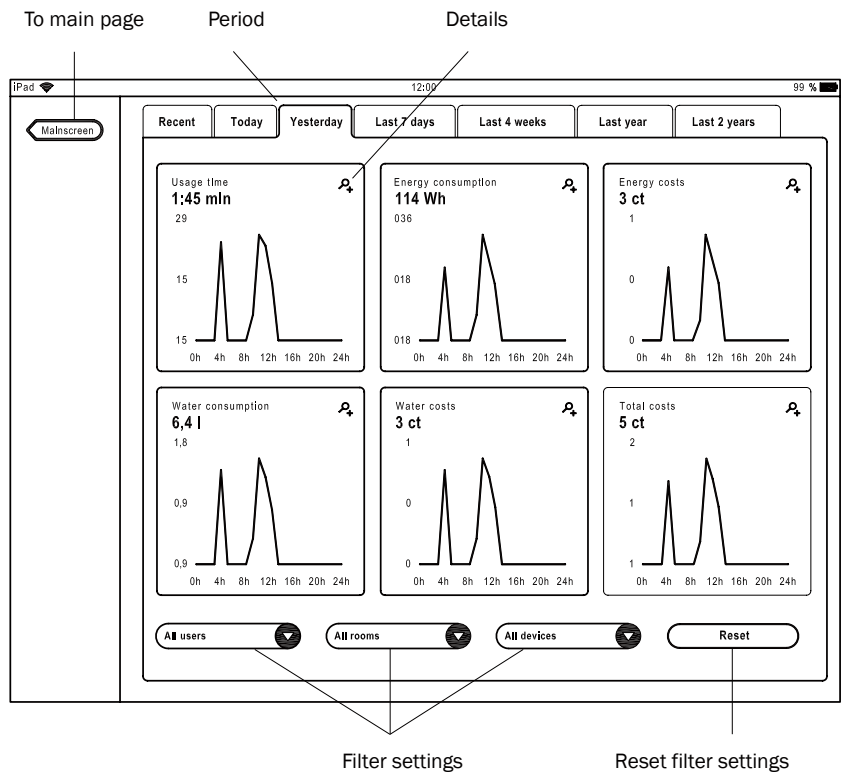

Figure 8: “Statistics”

The data on consumption and use can be seen on the “Statistics” screen. For the correct display of costs, the current prices for electricity and water must be entered in the “Settings” menu item in the configuration menu.

Note: The data of consumption and use are not suitable for billing purposes. After power failure, the system time on the Home Server must be synchronised either with an iPad or a timer server on the internet. Any tapping before the synchronisation of the system time will be misdated.

The data of consumption and use of the previous 15 minutes may be lost after each power failure at the home server.

4.5 Restoring the factory settings

4.5.1. Resetting the control app

If you want to restore the delivery status of the control app, you must uninstall the app and reinstall it via the AppStore.

Make the settings according to the “Initial operation” chapter.

Note: We recommend saving the configuration after you have completed the setting. Thus it is possible to download any configuration saved on the Home Server if required or after reinstallation. To this end, you must access the “Settings” menu item and select the “Configurations” tab. Any saved configuration can be selected from the pull-down menu.

4.5.2 Resetting of the home server

For access to the home server, for example after having changed passwords, you must disconnect the power supply plug from the socket and plug it in after an instant. After the completed restart (which may take up to a minute), the Home Server is in the delivery status as access point for three minutes. During this time, the status LED will light up continuously. For Wi-Fi configuration changes on the home server, you can log in your iPad on the Home

Server as follows:

Wi-Fi name = CLAGE-HS-... (followed by the last four digits of the MAC address printed on the nameplate)

Password = “Warmwasser” (without quotation marks)

Note: If no changes are made in these three minutes, the Home Server automatically starts the (Wi-Fi) configuration which was activated at last.

4.6 Cleaning and care

Do not subject the Home Server and its corresponding power pack to humidity. Otherwise you risk damage to the electricity. For any cleaning which is required nevertheless, you must remove the plug from the socket and use a soft and dry cloth for wiping the surfaces. Do not use any solvents for cleaning.

5. Self-help in case of problems, and customer service

Your CLAGE Home Server was produced with care and cross-checked before delivery. Problems that might occur are often the result of minor causes. Check whether you can probably solve the problem on the basis of the annexed table. Thus you help avoid costs for unnecessary customer service.

Problem	Possible cause	Remedy
App cannot find home server	Home server not activated	Connect Home Server with power pack
	Wi-Fi range exceeded	Position iPad closer to the access point (router or home server)
		Connect external antenna to the home server
	Wi-Fi deactivated on the iPad (air plane mode)	Activate Wi-Fi
	home server Instantaneous water heater	Change Wi-Fi in your iPad settings
App cannot find a certain instantaneous water heater	not turned on	water heater
	Distance between Home Server and instantaneous water heater too large	Change the orientation of the Home Server and thus the orientation of its internal antennas
		Position Home Server closer to the instantaneous water heater
App cannot find any instantaneous water heater	Home server not activated	Connect Home Server with power pack
Instantaneous water heater does not react to the app	Unstable Wi-Fi connection	Position iPad closer to the access point (router or home water heater)
	Instantaneous water heater not turned on	Check fuses for instantaneous water heater
	Device logged out from the home server	Log in the device on the home server

Self-help in case of problems, and customer service

No power displayed on the app although water is running	Inlet temperature higher than set point	No solution required
Displayed temperature changes	Manual control of the device	Coordinate use
	Manual control on the FX radio remote control	Coordinate use
	Control on a second iPad	Coordinate use
	Scalding protection activated	Deactivate scalding protection on the instantaneous water heater
Flashing status LED	Internal error	Contact customer service

5.1 Customer service address

If it is not possible to solve the problem, please contact

German Pool (Hong Kong) Limited

8/F, China Travel (Cargo) Logistics Centre 1 Cheong Tung Road Hung Hom, Kowloon, Hong Kong

Telefon: +852 2333 6249

Telefax: +852 2356 9798

Email: repairs@germanpool.com

Internet: www.GERMANPOOL.com

In case of defects, please return the device for inspection and / or repair and enclose a cover letter and a proof of purchase.

Disposal

Environment and recycling

Your product has been designed and produced on the basis of high-quality materials and components which can be recycled and reused. This symbol on products and/or accompanying documents means that electrical and electronic products must not be disposed of together with the household garbage after the expiration of their service life. Please take these products to your local collection point or recycling station for treatment, material recovery and recycling. These devices will be accepted free of charge.

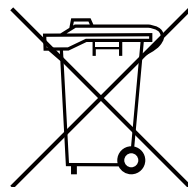

The correct disposal of this product contributes to environmental protection and prevents possible adverse impacts on human beings and the environment which might result from the incorrect handling of the devices at the end of their service life. Your local authorities will inform you about the nearest collection point and/or recycling station. Business customers: Please contact your dealer or supplier for the disposal of electrical and electronic devices. They will provide you with further information. This symbol is only applicable in the European Union.

**GERMAN
POOL**



德國寶

德國寶 (香港) 有限公司 German Pool (Hong Kong) Limited

中國香港 Hong Kong, China

香港九龍土瓜灣馬頭角道116號
新寶工商中心2期113號室
Room 113, Newport Centre Phase II, 116 Ma Tau
Kok Road, Tokwawan, Kowloon, Hong Kong.
電話 Tel: +852 2773 2888
傳真 Fax: +852 2765 8215

中國內地 Mainland China

廣東省佛山市順德區
大良南國東路德順廣場三層
3/F, Takshun Plaza, Nanguo East Road,
Shunde, Foshan, Guangdong
電話 Tel: +86 757 2980 8308
傳真 Fax: +86 757 2980 8318

中國澳門 Macau, China

澳門宋玉生廣場263號
中土大廈15樓I座
Alameda Dr. Carlos D'Assumpcao No. 263,
Edif. China Civil Plaza, 15 Andar, I. Macau
電話 Tel: +853 2875 2699
傳真 Fax: +853 2875 2661



© 版權所有。未獲德國寶授權，不得翻印、複製或使用本說明書作任何商業用途，違者必究。

© All rights reserved. Copying, reproducing or using the contents of this manual is not allowed without prior authorization from German Pool, violators will be prosecuted.

www.germanpool.com